

## INSTALLATION AND OPERATING INSTRUCTIONS

Wall Control

Availability of replacement parts, repair services, and information for maintenance or repair

Spares parts

Repair services

Information for maintenance or repair

Customer maintenance covered in Owner's Manual

Repair/Service Manual available to authorized dealer/contractor only

Model No. **FV-SCVE2**

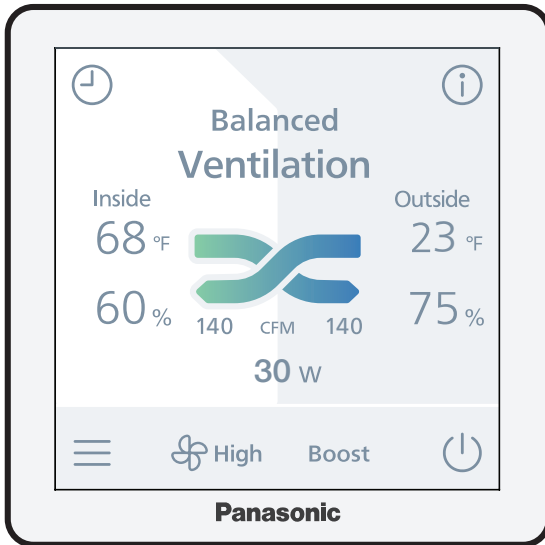

### CONTENTS

IMPORTANT SAFETY INFORMATION	2
SUPPLIED ACCESSORIES	3
DIMENSIONS	4
INSTALLATION	5
DISPLAY DESCRIPTION	11
OPERATION	12
TROUBLESHOOTING	16
SPECIFICATIONS	17
SERVICE	17

- The display will vary based on the connected model.



- Scan QR code for more resources

### APPLICABLE PRODUCTS:

- |             |             |             |             |
|-------------|-------------|-------------|-------------|
| •FV-11ES1   | •FV-12ESC1  | •FV-12VE1S  | •FV-12VE1T  |
| •FV-13VEC1S | •FV-13VEC1T | •FV-14ES1   | •FV-15VE1S  |
| •FV-15VE1T  | •FV-15ESC1  | •FV-16VEC1T | •FV-16VEC1S |

### READ AND SAVE THESE INSTRUCTIONS

Thank you for purchasing this Panasonic product. Read these instructions carefully before attempting to install, operate or service the Panasonic product. Carefully read the “IMPORTANT SAFETY INFORMATION”. Failure to comply with instructions could result in personal injury or property damage. Explain to users how to operate and maintain the product after installation and this manual should be presented to users. Retain this manual for future references.



# IMPORTANT SAFETY INFORMATION

## For Your Safety





To reduce the risk of injury, loss of life, electric shock, fire, malfunction, and damage to equipment or property, always observe the following safety precautions.

## Explanation of symbol word panels

The following symbol word panels are used to classify and describe the level of hazard, injury, and property damage caused when the denotation is disregarded and improper use is performed.









 <b>WARNING</b>	Denotes a potential hazard that could result in serious injury or death.
 <b>CAUTION</b>	Denotes a hazard that could result in minor injury.
<b>NOTICE</b>	Denotes a hazard that could result in property damage.

The following symbols are used to classify and describe the type of instructions to be observed.

	This symbol is used to alert users to a specific operating procedure that must be followed in order to operate this unit safely.
	This symbol is used to alert users to a specific operating procedure that must not be performed.
	This symbol is used to alert users not to disassemble the equipment.
	This symbol is used to alert users to make sure of grounding when using the equipment with the grounding terminal.

## WARNING

TO REDUCE THE RISK OF FIRE, ELECTRIC SHOCK OR INJURY TO PERSONS, OBSERVE THE FOLLOWING:

-  Do not install using methods not approved in the instructions.
-  Installation must be performed by qualified person(s) in accordance with applicable codes and standards, including fire-rated construction. Otherwise, a fire may be caused.
-  Disconnect power source before working on the product.
-  Do not disassemble the unit. It may cause fire or electric shock.
-  Do not spray flammable cleaner directly onto the controller.
-  Do not touch the controller with wet hands or pour water on the controller, it may cause fire or electric shock.
-  Do not install in a place where flammable gas may leak.
-  Discontinue use immediately if abnormal operation occurs.
-  Do not use the unit for any purpose other than is what is intended.

**⚠ CAUTION**

- ⚠ Please wear appropriate personal protective equipment.
- ⚠ Where appropriate, use the special-purpose or dedicated parts, such as the provided mounting fixtures, otherwise personal injury may result.
- ⚠ Inspect all wiring connections ensuring they meet the correct current capacity.
- ⚠ Disconnect power by switching off wall control first, then main switch and unplug the power plug before working on unit.

**NOTICE**

- ⊘ Haveily press may cause a fault code, electric shock and screen breackage.
- ⚠ Select a location where the device can be easily installed and accessed.
- ⚠ Select a location where the device will stay dry and not directly exposed to sunshine.
- ⚠ Select a flat location to prevent distortion. (Distortion may damage the wall control or cause a fault code).
- ⚠ If the screen position is not adequate, it may be difficult to view the display screen, it's important to select the position where it can be easily viewed and accessed. (Standard height is about 5 ft (1.5m) from the ground).
- ⚠ As shown in the figure, please secure the enough space around the wall control for a correct installation.

Unit: Inches (mm)

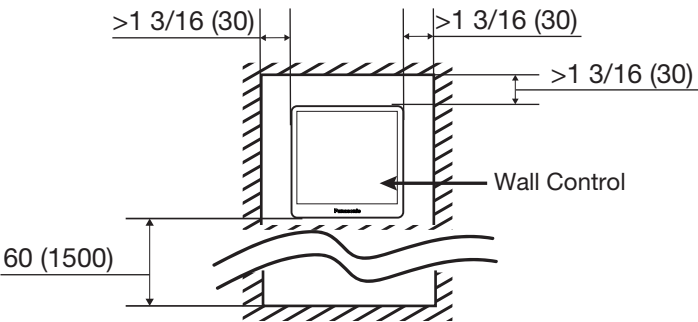

**SUPPLIED ACCESSORIES**

Part Name	Appearance	Quantity
Wall Control		1
Screw (M4X20)		2
Wall anchors		2
Installation and operating instructions		1

# DIMENSIONS

Unit: Inches (mm)

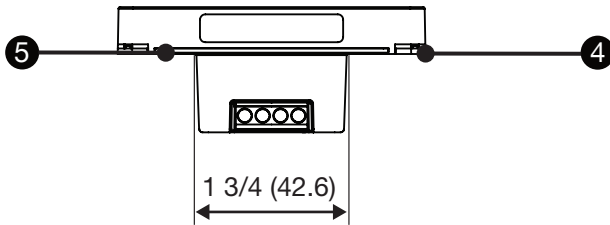
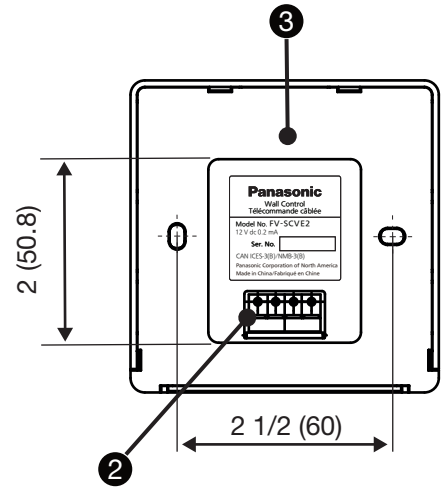
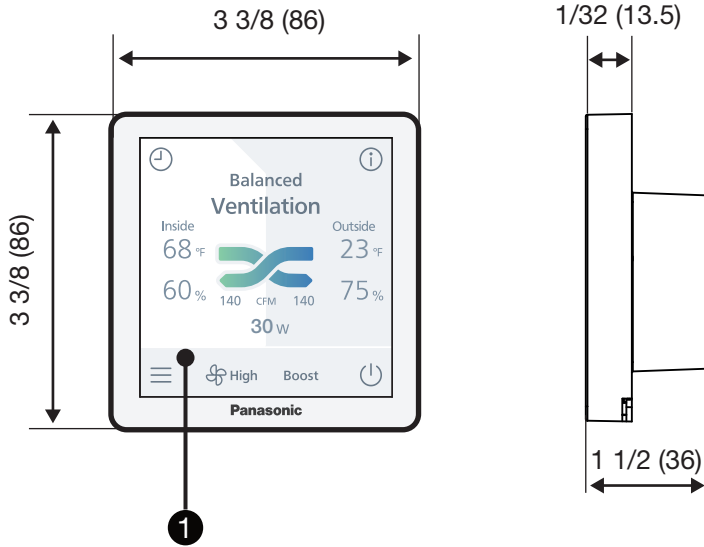

No.	Part Name
1	Screen
2	Terminal
3	Back cover
4	Recessed cut out
5	LED Light

## 1 ERV WIRING PREPARATION

### ⚠ CAUTION

! It's recommended to use the cable (14AWG ~ 24AWG) for connecting product and wall control, and the length should not be longer than 33.3 ft (10 m).

### NOTE

Strip insulation cover for each wires as shown below.

Unit: Inches (mm)

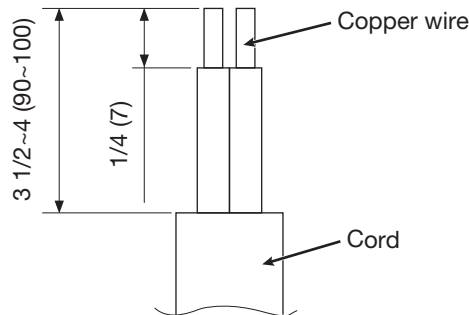

**FCC Note:** This equipment has been tested and found to comply with the limits for a Class B digital device, pursuant to Part 15 of the FCC Rules. These limits are designed to provide reasonable protection against harmful interference in a residential installation. This equipment generates, uses and can radiate radio frequency energy and, if not installed and used in accordance with the instructions, may cause harmful interference to radio communications. There is no guarantee that interference will not occur in a particular installation. If this equipment does cause harmful interference to radio or television reception, which can be determined by turning this product on and off, the user is encouraged to try to correct the interference by one of the following measures:

- Reorient or relocate the receiving antenna.
- Increase the separation between the equipment and receiver.
- Connect equipment to an outlet on a different circuit from that to which the receiver is connected.
- Consult the dealer or an experienced radio/TV technician for help.

**Warning:** This equipment must be installed by qualified person in accordance with the provided installation instructions; and all applicable codes and standards. Also, any changes or modifications not expressly approved by the party responsible for compliance could void the user's authority to operate this equipment.

**SDoC Responsible Party:** Panasonic Corporation of North America  
Two Riverfront Plaza, Newark, NJ 07102

**Customer Call Center:** 1-866-292-7299 (USA) or 905-238-2348 (Canada)

This device complies with Part 15 of the FCC Rules. Operation is subject to the following two conditions: (1) This device may not cause harmful interference, and (2) this device must accept any interference received, including interference that may cause undesired operation.

- ❶ Insert wires into the corresponding terminals deeply through the wire holders. Make sure the screw of the terminal securely fastens the copper wire and the copper wire is not exposed.
- ❷ Firmly connect the removable terminal block into terminal block.

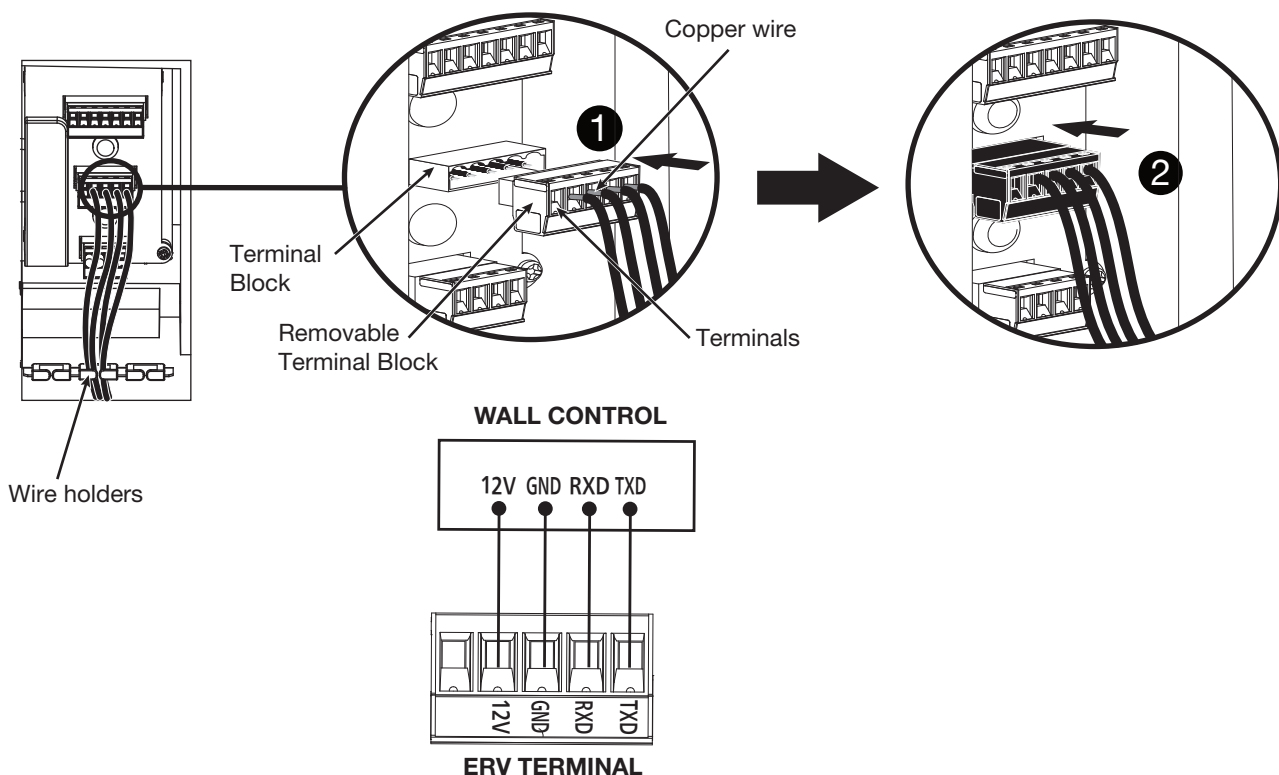

## 2 REMOVE BACK COVER

- ❶ Remove the back cover with a small flat screwdriver.
- ❷ Carefully disconnect the cable that is connected to the plate.

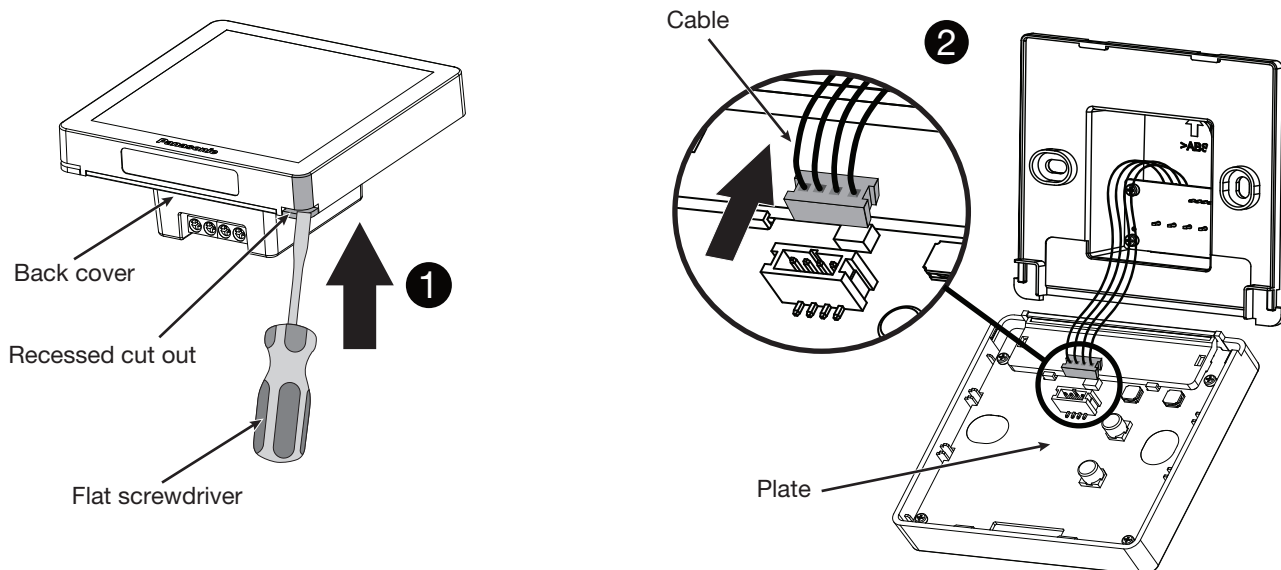

# 3 WALL PERFORATIONS

- 1 Temporarily put the back cover on the wall, mark terminal hole and screw position. Ensure that there is no obstructions behind location of that would interfere with hole and clear of any electrical lines.
- 2 Remove the back cover, cut the terminal hole, drill the screw holes (Ø5/32 inches (Ø4mm)) and introduce the wall anchors.

Unit: Inches (mm)

Back cover

1

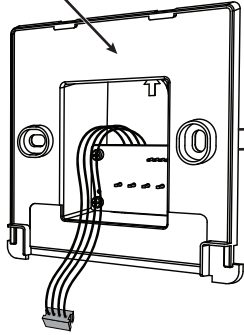

Wall

2 1/2 (60)

2 (50.8)

1 3/4 (42.6)

Wall anchors

Drill screw hole

Terminal hole

# 4 INSTALL BACK COVER

## CAUTION

- ! Make sure cables are not caught by circuit-board or resin clip. Otherwise, it may cause electrical leakage.
- ! Don't press firmly the screen, it may cause distortion or break

- 1 Route the wires from the unit to terminal hole.
- 2 Insert the wires into corresponding terminals of wall control according to lead wire diagram.
- 3 Fix the back cover on the wall with 2 screws.

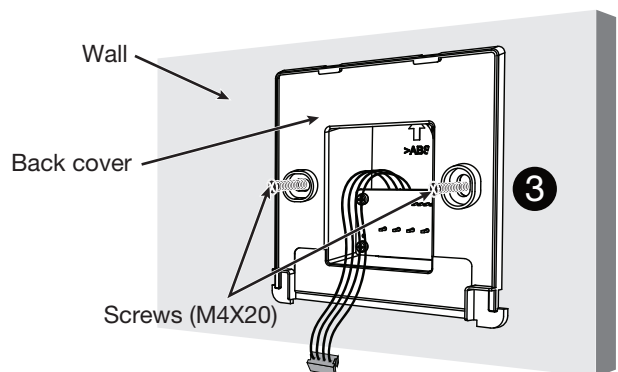
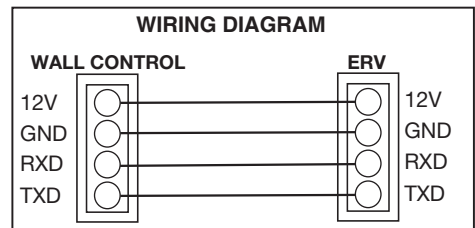
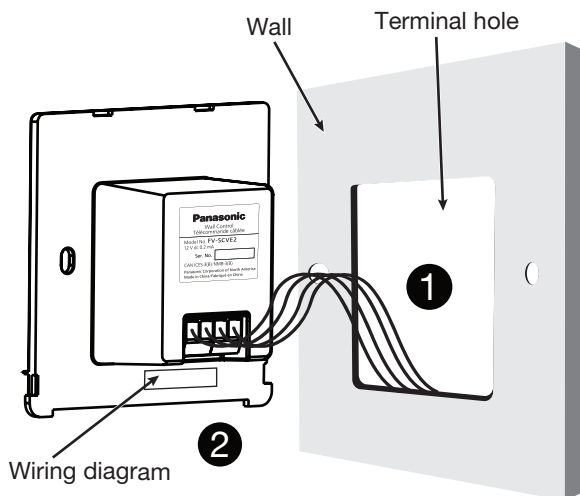

## 5 INSTALL WALL CONTROL SCREEN

- 1 Carefully connect the cable to the plate.
- 2 Fix the screen to the back cover.

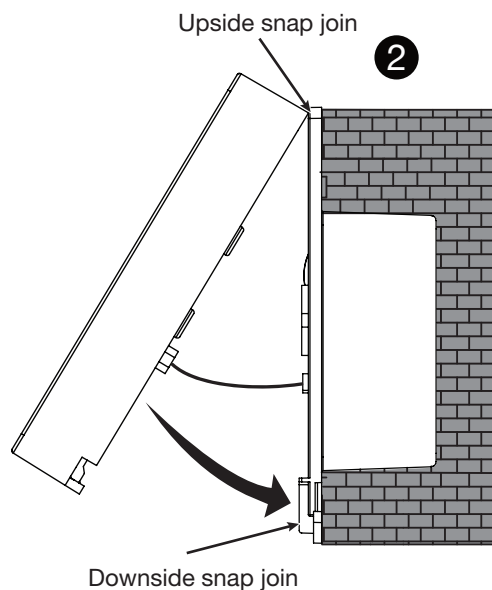
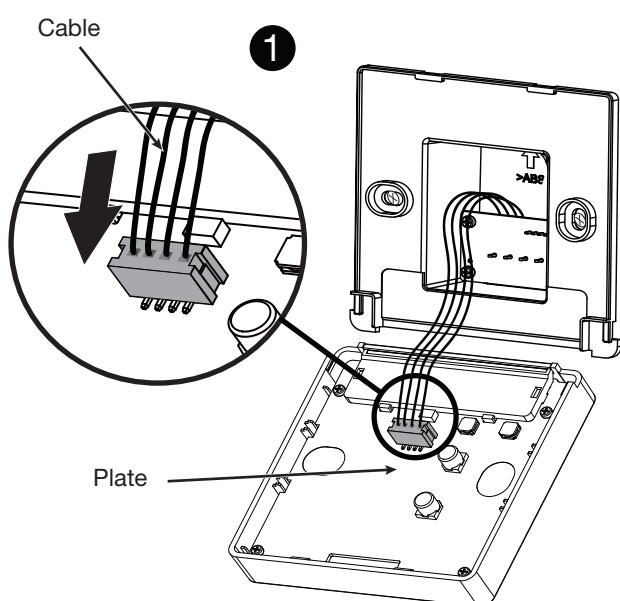

## 6 ADVANCED SETTINGS

### NOTE

This section is only for configuration of the installer.

- 1 Tap power icon to turn ON the unit.
- 2 To access this interface, touch the MENU.
- 3 Then you must press the setting “Gear icon” for 5 seconds.

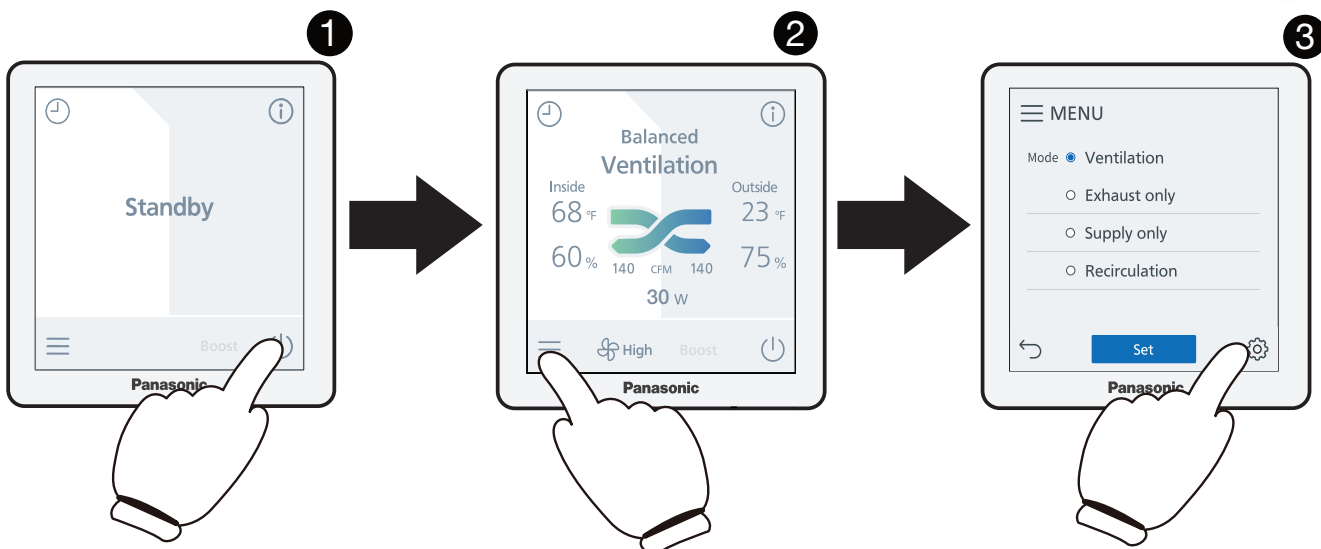

THE DISPLAY WILL VARY BASED ON THE CONNECTED MODEL



Next, the following warning will appear. Please read the security information carefully, and if all the information has been verified, press 'Confirm'.



This display is only available on **FV-11ES1, FV-14ES1, FV-12ESC1** and **FV-15ESC1** models.

Here, you can adjust more specific parameters according to what is required.

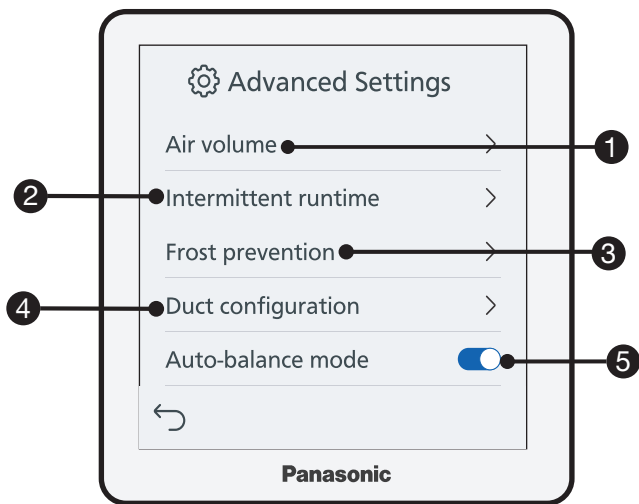

### 1 Air volume

The air volume adjustment can be made according to the configuration restrictions.  
•Press “Set” button to apply the modifications.

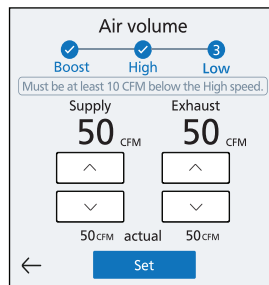
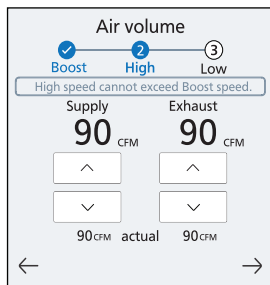
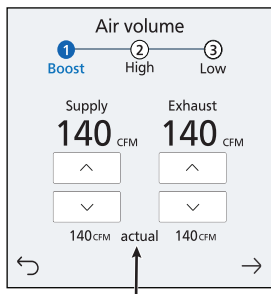

These are the actual air volume.  
After setting up, please check the actual air volume to match the set air volume.

## ② Intermittent runtime

•It is used to establish a pause time in operation.

•**Automatic runtime ON:** The run time will be automatically set according to outdoor temperature. To know more refer to the ERV manual.

Intermittent Runtime

Automatic runtime ☒

30 min/h

When not ventilating:

☒ Standby ☐ Recirculation

Set

## ③ Frost prevention

•You can select one of the options where frost prevention will be established.

•Frost prevention will operate automatically based on outdoor temperature.

Frost Prevention

☐ Recirculation

☒ Exhaust only

Set

## ④ Duct configuration

Please refer to the ERV unit manual for the duct configuration explanation.

Duct Configuration

☐ DC1

☒ DC2

☐ DC3

☐ DC4

☐ DC5

Set

## ⑤ Auto-balance mode

Activates or deactivates the automatic adjustment of airflow based on the needs of the space.

Advanced Settings

Air volume >

Intermittent runtime >

Frost prevention >

Duct configuration >

Auto-balance mode >

Set

# DISPLAY DESCRIPTION

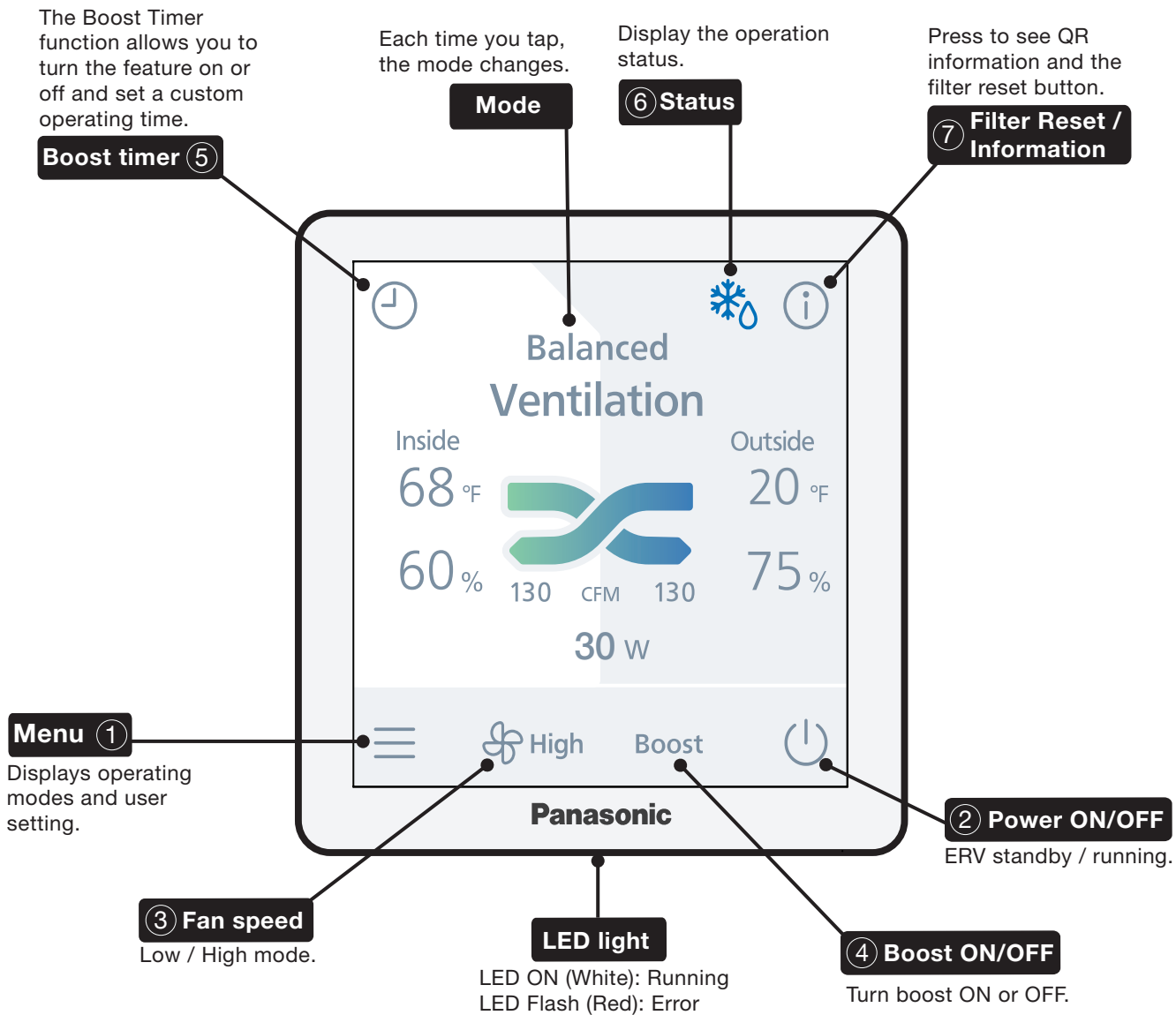

## THE DISPLAY WILL VARY BASED ON THE CONNECTED MODEL

Temperature and humidity readings are not available on **FV-11ES1, FV-12VE1S, FV-12VE1T, FV-14ES1, FV-15VE1T, FV-15VE1S** models.

## 1 MENU

Displays the different operating modes of the ERV. Allows access to user settings and advanced settings.

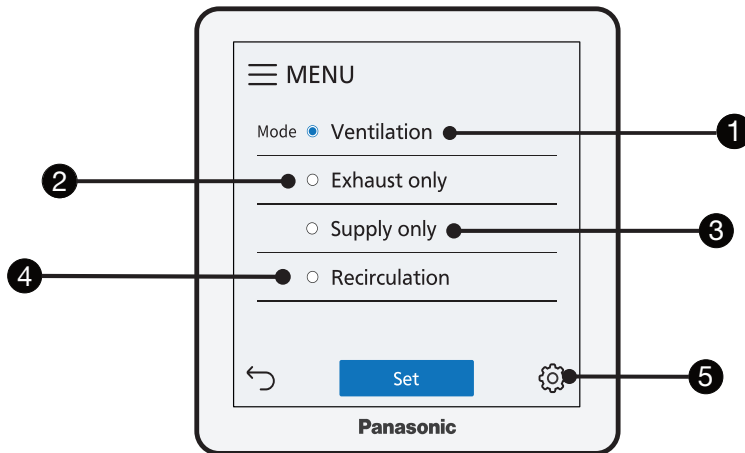

### 1 Ventilation

Reduces the pressure state that allows the entry of fresh air and prevents the accumulation of contaminants. Display differs depending on supply and exhaust air volume.

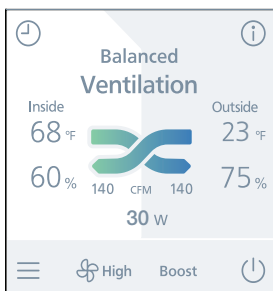

When “Supply” is EQUAL to “Exhaust”.

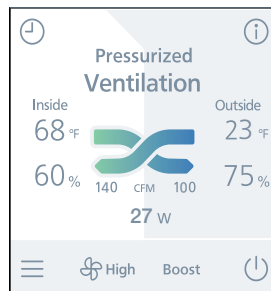

When “Supply” is HIGHER than “Exhaust”.

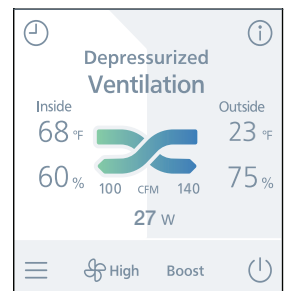

When “Supply” is LOWER than “Exhaust”.

### 2 Exhaust only

It focuses on the extraction of indoor air, expelling it outside to eliminate contaminants in the environment.

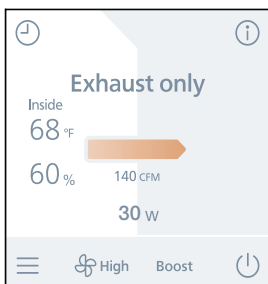

### 3 Supply only

This mode allows the entry of fresh air into the interior without extracting the indoor air.

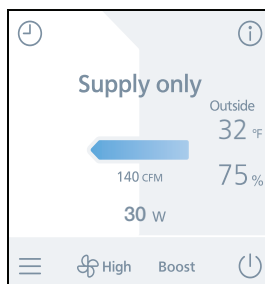

### 4 Recirculation

This process takes the indoor air, which is filtered and returned back to the interior. This mode cannot be selected in case of DC4 or DC5 duct configuration.

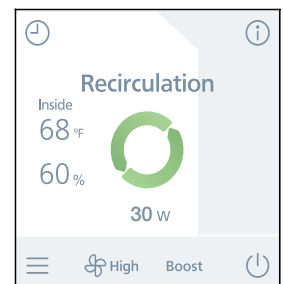

## 5 USER SETTINGS

In this section, various aspects can be found for modification at the user's discretion.

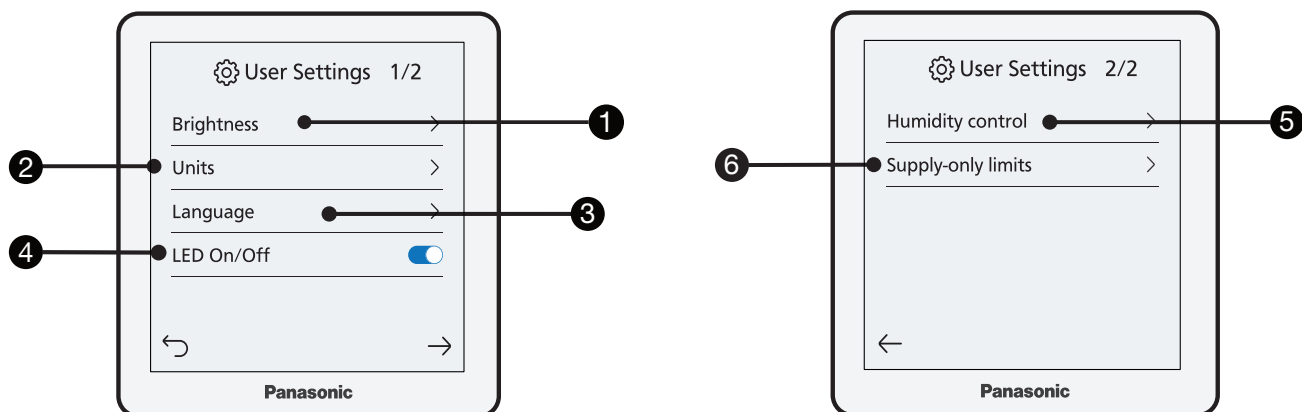

### 1 Brightness

Modifies the brightness control of the device.

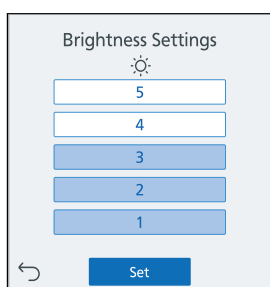

### 4 LED On / Off

Activates or deactivates the LED light.

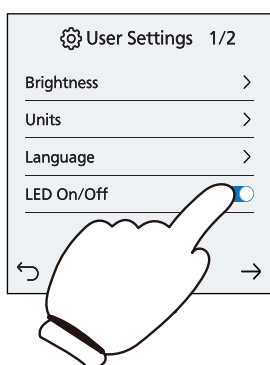

### 2 Units

Allow changing units for temperature and fan speed.

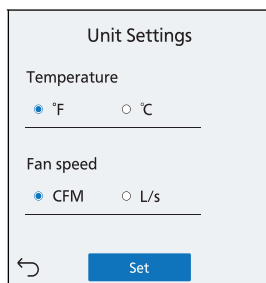

### 5 Humidity control

Allows configuration of external and internal humidity control.

**Humidity control ON:** Boost function will be performed when the indoor humidity (RA) exceeds the set value.

**Outside humidity sensing ON:** When boost function is performed by humidity control, boost will only be performed when the indoor humidity is higher than the outdoor humidity.

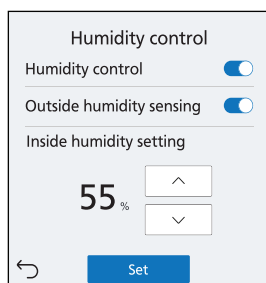

### 3 Language

Language selection: English, French and Spanish.

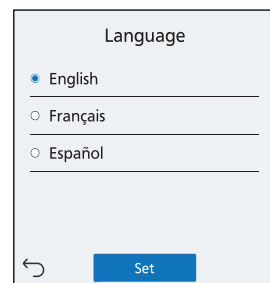

### 6 Supply-only limits

Can be modified based on a low temperature and adjust the humidity parameter by high percentage.

This setting is only valid for Supply air mode:

**Low temperature ON:** Air supply stops when the OA temperature falls below the set temperature set by the user.

**High humidity ON:** Air supply stops when the OA humidity exceeds the set humidity set by the user.

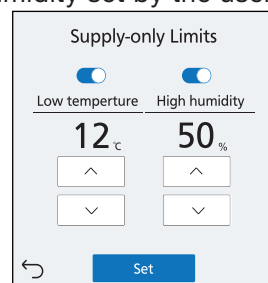

## ② POWER ON/OFF

Touch to change ON or OFF (Standby).

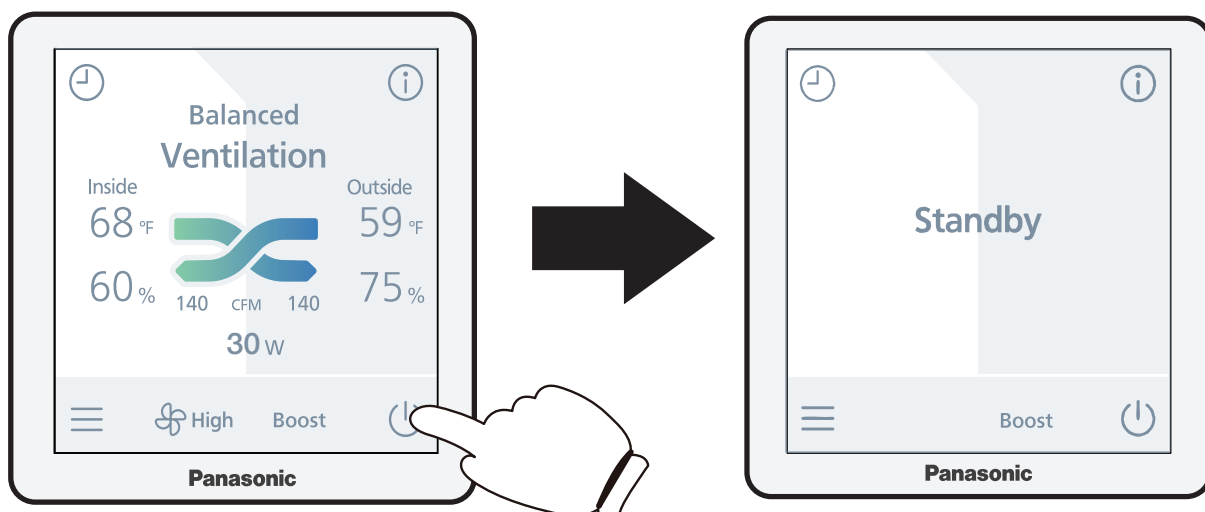

## ③ FAN SPEED

Touch to change High / Low.

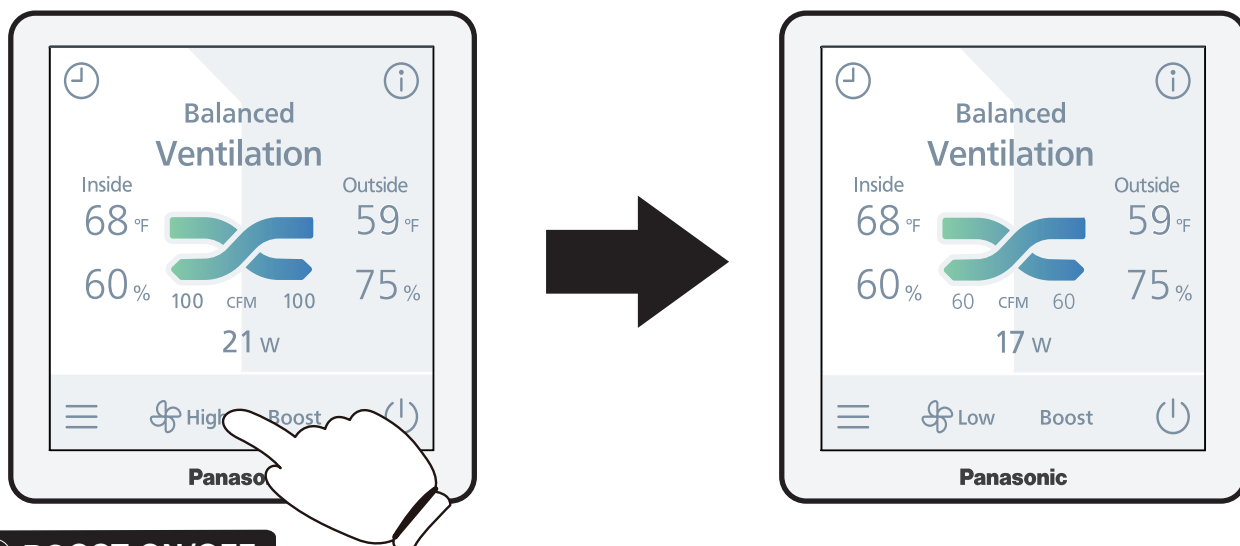

## ④ BOOST ON/OFF

Touch to change Boost ON/OFF.

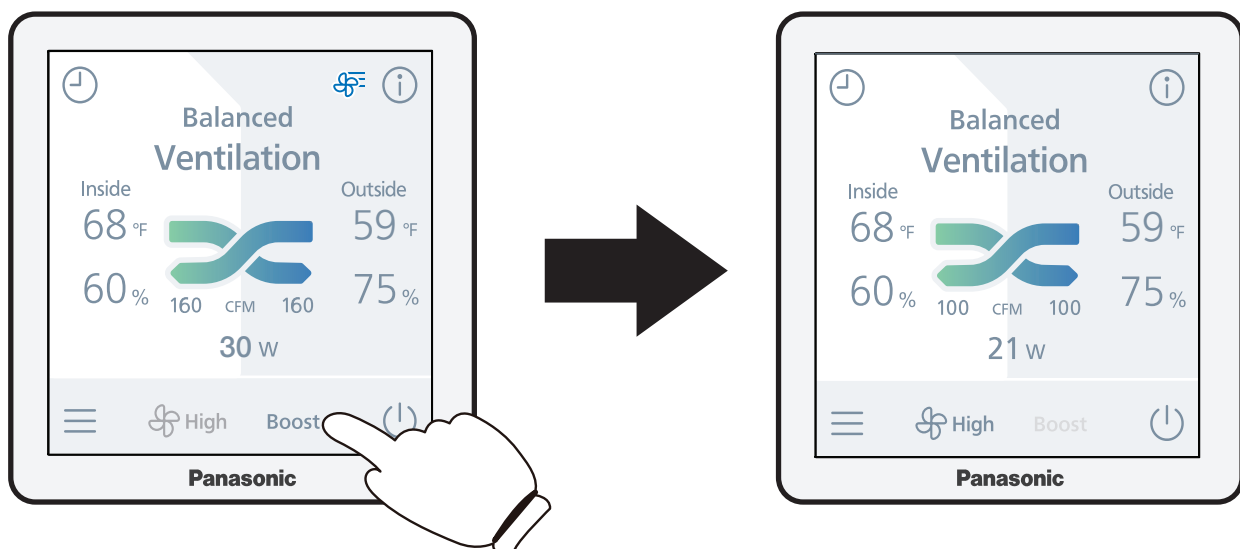

## ⑤ BOOST TIMER

Touch to change ON or OFF, the time can be programmed from 10 minutes to 12 hours. Once the time is programmed, press the “Set” button to apply the settings.

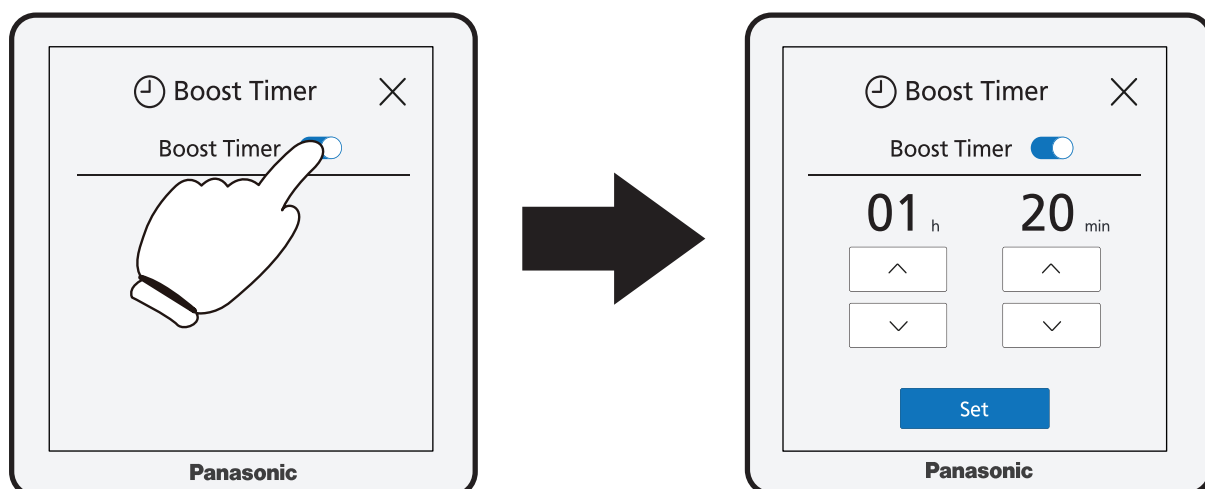

## ⑥ STATUS

Touch to check the current status.

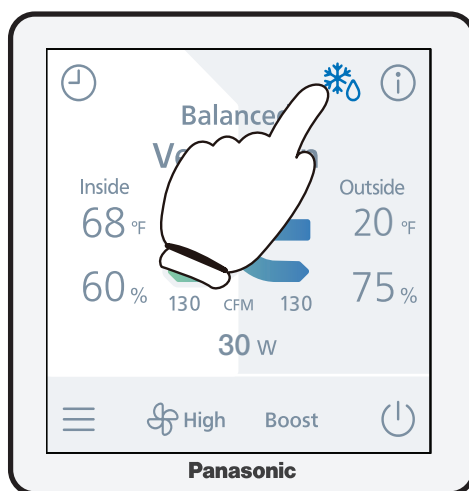

Icon	Operation Status
	Frost prevention mode operation
	Humidity control operation
	Automatic runtime operation
	Intermittent runtime operation
	Supply-only limits: Automatically stop due to low temperature or high humidity
	Boost operation
	Balanced operation with other ventilation fan
	AHU Mode: Air flow automatically increased due to pressure from AHU

## 7 FILTER RESET / INFORMATION

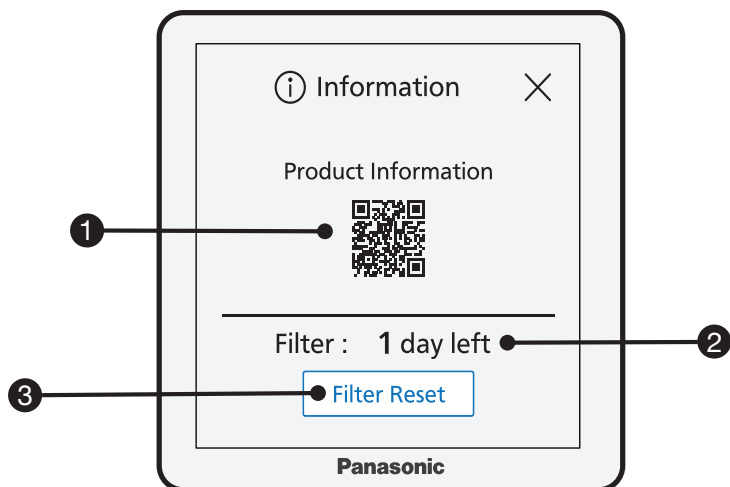

1 Scan the QR code to get more information about the product.

2 Indicates the remaining days to change the filter showing the next display.

3 Press the button to reset the countdown for the next maintenance.

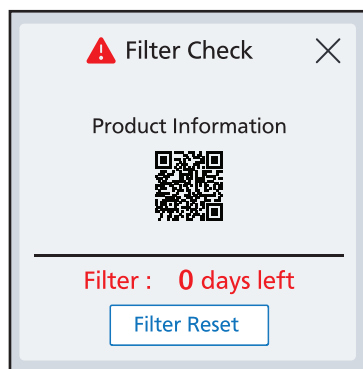

## TROUBLESHOOTING

If product is malfunctioning, a fault code will display. Please reference the following codes below.

Fault Code	Problem	Action
F01	Wall control communication error	Please disconnect the power and contact the dealer to check the wall control wiring connect.
F03	Motor communication error	Please disconnect the power and contact the dealer for repair.
F04	Sub communication error	Please disconnect the power and contact the dealer for repair.
F10	OA temperature sensor error	Please disconnect the power and contact the dealer for repair.
F11	OA humidity sensor error	Please disconnect the power and contact the dealer for repair.
F12	RA temperature sensor error	Please disconnect the power and contact the dealer for repair.



Fault Code	Problem	Action
F13	RA humidity sensor error	Please disconnect the power and contact the dealer for repair.
F60	SA air volume error	Please disconnect the power and contact the dealer for repair.
F20	SA motor error	Please disconnect the power and contact the dealer for repair.
F21	EA motor error	Please disconnect the power and contact the dealer for repair.
F30	Damper error	Please disconnect the power and contact the dealer for repair.
F61	EA air volume error	Please disconnect the power and contact the dealer for repair.
H31	OA damper connection failure	Check the damper connection.
H32	OA damper connection failure	Check the damper connection.
H33	OA damper connection failure	Check the damper connection.
H60	SA air volume drop error	Please disconnect the power and contact the dealer for repair.
H61	EA air volume drop error	Please disconnect the power and contact the dealer for repair.



• Scan QR code to more information about troubleshooting

## SPECIFICATIONS

Model No.	Voltage (v)	Power Consumption (W)	Net Weight lb.( kg )
FV-SCVE2	DC 12 V	1.8	0.26 (0.119)

## PRODUCT SERVICE

Warning Concerning Removal of Covers.  
The unit should be serviced by qualified technicians only.  
Your product is designed and manufactured to ensure a minimum of maintenance.  
Should your unite require service or parts, call Panasonic Call Center at 1-866-292-7299 (USA) or 905-238-2348 (Canada).